

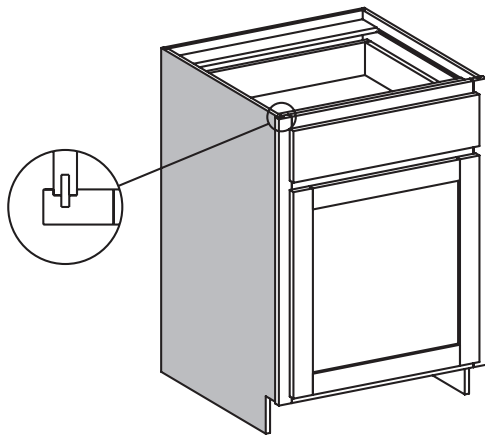

Exposed Ends (EXP)



D	DF	DB	EXT	EXP	FL	WS	MI	FT
				✓				

- Matching specie veneer on 1/2" thick cabinet sides
- Available in both Advantage and Essence lines
- Specify: "L" (Left), "R" (Right) or "B" (Both)
- 9/32" reveal from edge of front frame to surface of the side
- Soft Maple and Hard Maple cabinets have Hard Maple exposed ends
- Pricing: per cabinet, per side – Advantage: use exposed end pricing column
Essence: exposed end pricing unpublished.
Use OrderLink for pricing

Flush Ends (FL)

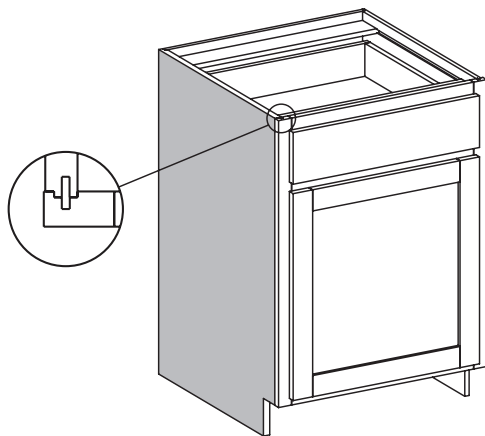

D	DF	DB	EXT	EXP	FL	WS	MI	FT
					✓			

- Matching specie veneer on 3/4" thick cabinet sides
- Available in Advantage line only
- Specify: "L" (Left), "R" (Right) or "B" (Both)
- 1/32" reveal from edge of front frame to surface of the side
- Soft Maple and Hard Maple cabinets have Hard Maple flush ends
- Pricing: per cabinet, per side – use flush end pricing column

Unfinished Flush Ends (UFL)

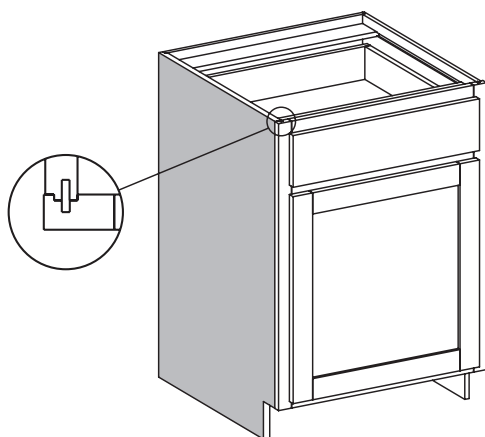

D	DF	DB	EXT	EXP	FL	WS	MI	FT
					✓			

- Shop grade veneer on 3/4" thick cabinet sides – finishing is not available
- Order when thicker, non-exposed sides are required for solid surface and stone counter tops
- Available in Advantage line only
- Specify: "L" (Left), "R" (Right) or "B" (Both)
- 1/32" reveal from edge of front frame to surface of the side
- Pricing: per cabinet, per side – use OrderLink or Conestoga order entry for pricing

Options Key: D=Number of Doors DF=Number of Drawer Fronts DB=Drawer Box EXT=Extended Stiles EXP=Exposed End FL=Flush End
WS=Solid Wood Shelf MI=Matching Interior FT=Flush Toe

Extended Stiles (EXT)

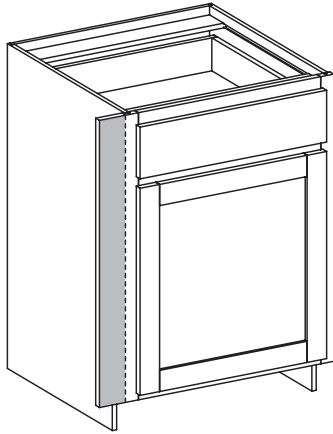

D	DF	DB	EXT	EXP	FL	WS	MI	FT
			✓					

- Adds 3" to the left, right or both stiles as an alternative to loose filler strips
- Specify: "ESL" (Extended Stile Left), "ESR" (Extended Stile Right) or "ESB" (Extended Stile Both)
- Total stile width is 4-1/2"
- 4-1/2" stiles are one piece without glue lines
- Available on most wall, base and tall units

Matching Interior (MI)

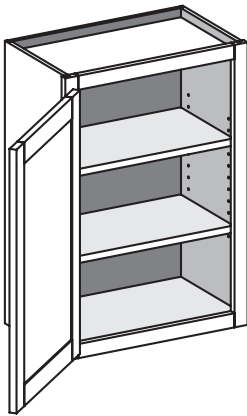

D	DF	DB	EXT	EXP	FL	WS	MI	FT
							✓	

- Cabinets will have unfinished matching specie interior sides, tops, bottoms, shelves and backs
- Available on Advantage line only
- Specify: "MI" (Matching Interior)
- Shelves are matching specie 3/4" plywood with veneer edgebanding on front edge
- Soft Maple and Hard Maple cabinets have Hard Maple veneered interior components
- Cabinets with matching interior standard do not have the matching interior upcharge included in the cabinet price
- Pricing: per cabinet – percentage upcharge per specie

Matching Specie Interior	
Specie	Percent Upcharge
Cherry	30%
Maple	25%
Red Oak	15%

Options Key: D=Number of Doors DF=Number of Drawer Fronts DB=Drawer Box EXT=Extended Stiles EXP=Exposed End FL=Flush End WS=Solid Wood Shelf MI=Matching Interior FT=Flush Toe



Flush Toe (FT)

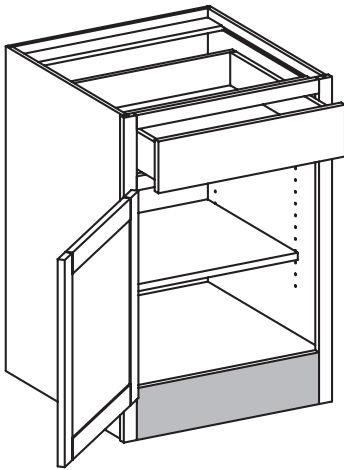

D	DF	DB	EXT	EXP	FL	WS	MI	FT
								✓

- Bottom rail height is 5-1/2"
- Specify: "FT" (Flush Toe)
- Cabinet side is manufactured without standard toe notch
- 96" tall cabinets do not use a toe platform
- Available on most base and tall cabinets

Dust Top (DT)

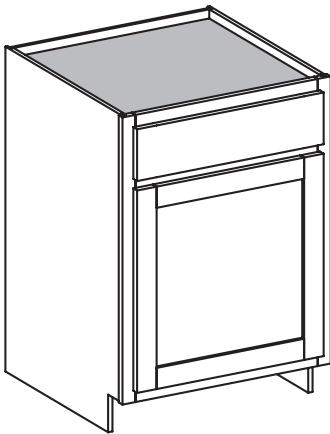

- Full top in place of front and back top strips
- Available on Advantage or Essence lines
- Specify: "DT" (Dust Top)
- Use OrderLink or Conestoga order entry for pricing

Prepare for False Door Side Option (PFD)

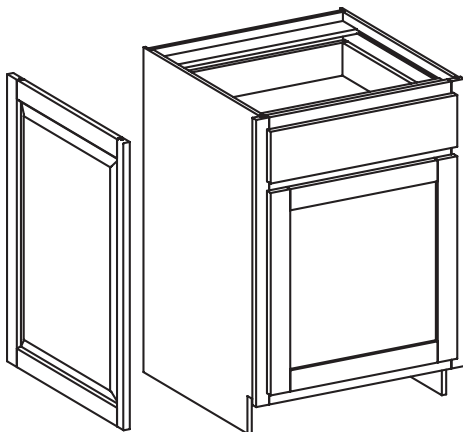

- Prepares the sides of wall, base, tall or vanity cabinets to accept 3/4" thick doors as decorative, integral cabinet sides
- Doors not included, must be ordered separately
- Cabinet carcass width is reduced to provide a 13/16" extension of the front frame on left, right or both sides. Overall cabinet front width remains unchanged
- Left and right stiles are 1-1/2" wide
- Available on Advantage or Essence Lines.
- Specify: "L" (Left), "R" (Right) or "B" (Both)
- Available on most wall, base and tall cabinets
- Pull-Out Trays (POT's) and Concealed Inset Hinges are not available with Prepare for False Door Side Option
- Use OrderLink or Conestoga order entry for pricing of Prepare for False Door Side Option
- Order door width 3/4" less than cabinet depth. Height of door equals cabinet height

Options Key: D=Number of Doors DF=Number of Drawer Fronts DB=Drawer Box EXT=Extended Stiles EXP=Exposed End FL=Flush End WS=Solid Wood Shelf MI=Matching Interior FT=Flush Toe

Solid Wood Shelf Upgrade

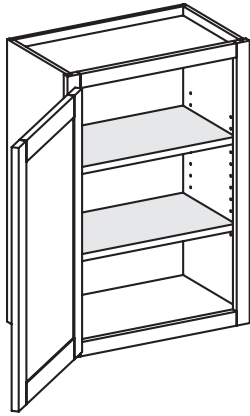

D	DF	DB	EXT	EXP	FL	WS	MI	FT
						✓		

- Replaces Advantage line 3/4" thick prefinished plywood shelving with 3/4" thick, prefinished solid wood shelving with a bullnose on front edge
- Solid wood shelves available up to 18" deep

Plywood Shelf Upgrade

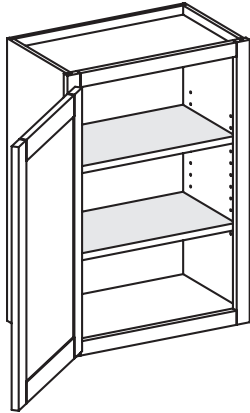

- Replaces Essence line 3/4" thick paper covered particle board shelving with 3/4" thick, prefinished plywood shelving

Options Key: D=Number of Doors DF=Number of Drawer Fronts DB=Drawer Box EXT=Extended Stiles EXP=Exposed End FL=Flush End
WS=Solid Wood Shelf MI=Matching Interior FT=Flush Toe



Toeboards

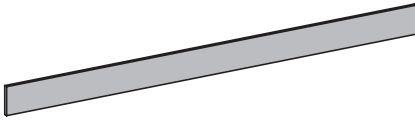

Plywood Toeboard Strips

- 1/2" thick 4" x 96" plywood strips available in Cherry, Hard Maple or Red Oak
- Order as a loose part; specify specie

Plywood Toeboard Strips TE5003 - 4"x96"

Specie	
Cherry	
Maple	
Red Oak	

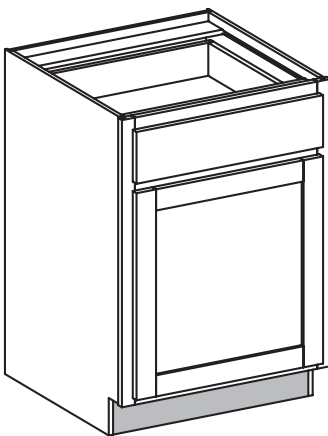

Plywood Toeboard Backer

- 1/2" thick unfinished plywood strips
- Designed to fully enclose base, tall and vanity toe spaces and provide a backer for finished toeboards or mouldings
- Backers are 4-15/16" high, sized to fit between cabinet sides in the toe space notch
- To order, check toeboard backer option

Toeboard Backer Option

Cabinet Width	
Less than 36"	
36-1/16" & above	

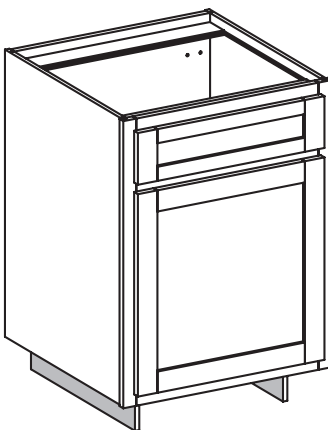

Toe Space Side Option (TSS)

- Places standard toe space depth on the left, right or both sides of most base cabinets
- Available in Advantage or Essence Lines
- Specify "TSS" "L" (Left), "R" (Right) or "B" Both
- Toe Space Side is not available on the following cabinets: BLS, BSC, BCFD, BAE, BEAL/R, DB, DBFD, DB2D, DB3D, LF2D, ORS, DWEP, REP, BFC, WSUD and FS

Options Key: D=Number of Doors DF=Number of Drawer Fronts DB=Drawer Box EXT=Extended Stiles EXP=Exposed End FL=Flush End
WS=Solid Wood Shelf MI=Matching Interior FT=Flush Toe

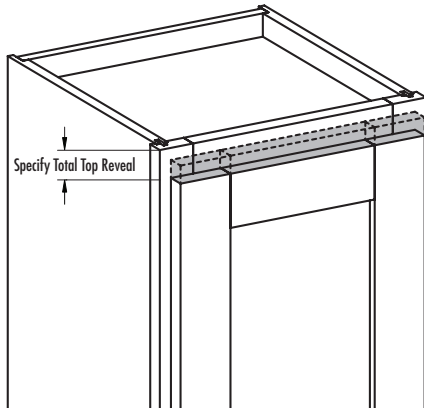
Custom Top Reveal (CTR)

- Reduces door height to attach decorative mouldings directly to a cabinet face frame.
- Left, right and bottom reveal remain unchanged
- Available with 1-1/4" and 1-3/8" overlay only
1-1/4" overlay – 1/2" top reveal is standard, CTR available – 9/16"- 1-1/4"
1-3/8" overlay – 1/4" top reveal is standard, CTR available – 5/16"- 1-1/4"
- Reveal can be specified in 1/16" increments
- Specify: "CTR" followed by the total amount of top reveal required
- Maximum reveal is 1-1/4"
- See the Doors/Overlay Options section for standard overlay rules

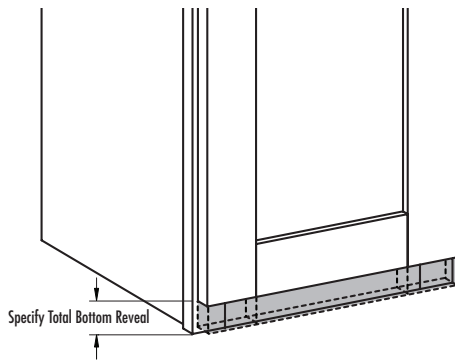
Custom Bottom Reveal (CBR)

- Reduces door height to attach light rail or decorative mouldings directly to the bottom rail of the cabinet face frame.
- Left, right and top reveal remain unchanged
- Available with 1-1/4" and 1-3/8" overlay only – max CBR 1-1/4"
- Reveal can be specified in 1/16" increments
- Specify: "CBR" followed by the total amount of bottom reveal required
- Maximum reveal is 1-1/4"
- See the Doors/Overlay Options section for standard overlay rules

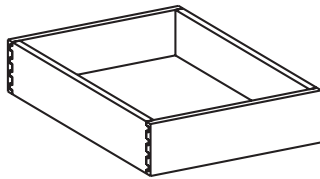
4 – Sided Dovetail Drawer Boxes

- English dovetail construction
- Advantage drawer sides and ends are 5/8" thick solid wood with 1/4" Birch plycore bottoms
- Essence drawer sides and ends are 5/8" thick plywood with 1/4" Birch plycore bottoms
- Drawer boxes are assembled and prefinished
- Drawer boxes can be ordered with bottom lip mount or undermount drawer slides and are packaged on a skid separate from cabinets
- Boxes will be notched and hook hole drilled accordingly, based on slide requirements. Appropriate upcharges apply
- Hard Maple, Soft Maple and Category 1 and 2 drawer boxes are available with Cabinet Systems orders; custom pricing and lead-times apply



Drawer Slide Options

Bottom Lip Mount Slides – STANDARD

- Blum** – Standard slide for drawer boxes on 18", 21" and 24" deep cabinets only.
STANDARD 230 Not available with wall cabinets or POT's.
 1/2" bottom reveal is standard.

Undermount Slide – Optional Upgrade

- Blum TANDEM Plus BLUMOTION** – Optional slide for drawer boxes on 18", 21" and 24" deep cabinets. Only slide option for drawer boxes on 12", 15", 27" and 30" deep cabinets.
 Full extension zinc coated steel with rear mount screw-in bracket (15", 18", 21" or 24" deep) or side mount with cleats (12", 27", or 30" deep) and integrated soft close.
 1/2" bottom reveal, undermount notch and hook hole required.
 Blum TANDEM sizing without slides also available.

Installation jigs for TANDEM (2100485A) rear brackets available from Conestoga:

Side Mount Slides

- Ball Bearing Full Extension** – Standard slide for wall cabinets and POT's when ordered with Blum STANDARD 230.
 Not available with base, vanity or tall cabinets.
 1/2" bottom reveal is standard.

Ordering - With Cabinet

Select Blum STANDARD 230 or Blum TANDEM Plus BLUMOTION from drawer boxes/drawer slides box on Cabinet Systems order form. Side mount slides will replace Blum STANDARD 230 slides as appropriate for specific cabinets.

Ordering - Loose Parts

Cabinet Depth	Blum STANDARD 230	Blum TANDEM Plus BLUMOTION	Ball Bearing Full Extension
12" Deep	—	2100497A	—
12-1/2" Deep	—	—	2100069A
15" Deep	—	2100498A	—
18" Deep	2100368A	2100476A	—
21" Deep	2100367A	2100475A	2100028A
24" Deep	2100366A	2100474A	2100027A
27" Deep	—	2100499A	—
30" Deep	—	2100500A	—

Cabinet Hinge Options

Blum Program Overview

- One piece steel, nickel plated concealed hinges designed for use with 3/4" thick front frames
- Hinges packed in pairs or bulk pack and include mounting screws, installation instructions and warranty information
- Hinge option is only available on door styles and edge profiles which support concealed hinge boring
- Doors over 42" high will receive 3 hinges
- Specify hinging left or right for single door cabinets if hinge boring option is selected
- Blum hinges carry a limited lifetime warranty

COMPACT BLUMOTION Hinge Program

Hinges with Integrated Soft Close

- Available for 1/2", 1-1/4" and 1-3/8" overlays
- Soft close feature is integrated in the hinge cup itself
- Soft close function can be easily deactivated with a switch on individual hinges as needed based on the door size and weight
- All hinges feature side, height, and depth adjustment for fine tuning door spacing with wraparound face frame mounting for ease of installation
- Blum COMPACT BLUMOTION hinges require Pattern "A" cup only boring
- Note: When 1-1/4" or 1-3/8" overlay is ordered, extended stiles or loose filler strips may be required in applications where cabinets are installed next to a tall cabinet, corner cabinet or a wall
- Hinges available in pairs or bulk pack (50 hinges per pack, including mounting screws)

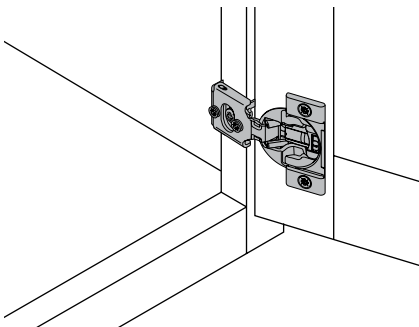

1/2" Overlay Hinge

Blum COMPACT BLUMOTION 38N 105° opening angle

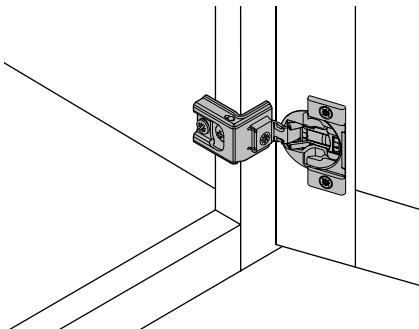

1-1/4" and 1-3/8" Overlay Hinge

Blum COMPACT BLUMOTION 39C 110° opening angle

Compact BLUMOTION Hinges (per pair)

Part #	Overlay	
2100150A	1/2"	
2100151A	1-1/4"	
2100152A	1-3/8"	

Compact BLUMOTION Bulk Pack Hinges (50 hinges)

Part #	Overlay	
2100153A	1/2"	
2100154A	1-1/4"	
2100155A	1-3/8"	



Cabinet Hinge Options

Blum Specialty Hinges

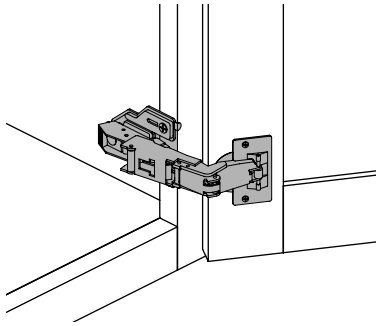

Blum 71T6550 hinge
Blum 175H6000 mounting plate

170° Hinges

- Provides full access to cabinet interiors with 170° opening angle
- Available with 1/2" overlay only. Will not work with inset door applications
- In 1-1/4" and 1-3/8" overlay applications, cabinets will have their doors sized as 1/2" overlay in width only
- Two-piece, clip style hinge with side, height and depth adjustment points
- 170° corner hinges require Pattern "B" cup only boring
- BLUMOTION soft close feature is not available
- Standard on WCP and BLS cabinets
- To order loose, specify part # 2100063A

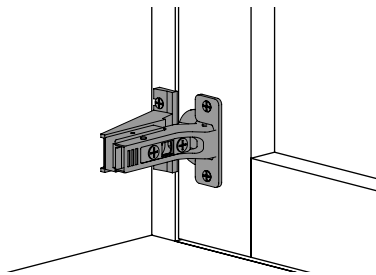

(view of inside of cabinet)

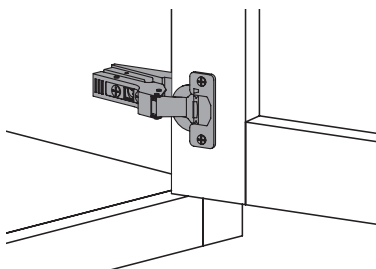

Blum 71B3650NI hinge
Blum 175H5030.21 mounting plate

Concealed Inset Hinges

- Hinge and mounting plate system for concealed inset applications with framed cabinetry
- Soft close feature is integrated in the hinge cup
- 120° opening angle
- Hinge packs include screws and two adjustable door stops with bumpers
- Concealed inset hinges require Pattern "B" cup only boring
- Door and front frame thickness must match.
- To order loose, specify part # 2100067A

Cabinet Hinge Options

Ferrari Program Overview

- One piece steel, self closing concealed hinges designed for use with 3/4" thick front frames
- Hinges packaged in pairs with mounting screws, installation instructions and warranty information.
- Hinge option is only available on door styles and edge profiles which support concealed hinge boring
- Doors over 42" high will receive 3 hinges
- Specify hinging left or right for single door cabinets
- Ferrari hinges carry a limited lifetime warranty

Overlay Hinges

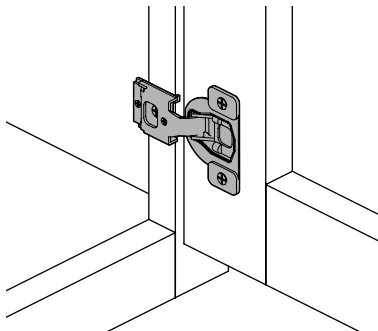

Ferrari Compacta 1/2" Overlay Hinge
105° opening angle

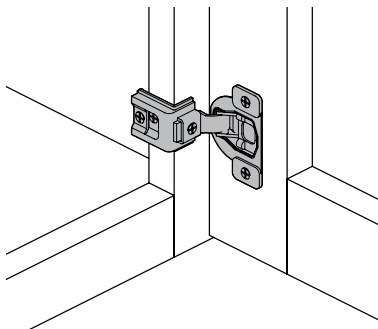

Ferrari Compacta 1-1/4" and 1-3/8" Overlay Hinge
110° opening angle

- Available with 1/2", 1-1/4" or 1-3/8" overlays
- All hinges feature side, height and depth cam style adjustment for fine tuning door spacing
- Ferrari hinges require Pattern "A" cup only boring
- Note: When 1-1/4" or 1-3/8" overlay is ordered, extended stiles or loose filler strips may be required in applications where cabinets are installed next to a tall cabinet, corner cabinet or a wall

Ferrari Hinges		
Part #	Overlay	
2100165A	1/2"	
2100166A	1-1/4"	
2100167A	1-3/8"	

Karma Soft Close Dampers for Doors

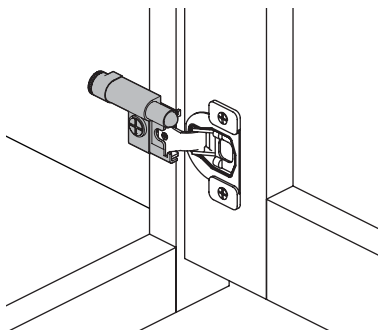

- Soft close damper designed for framed cabinetry
- Available for use with Ferrari Compacta hinges only
- One Karma damper is required for most doors, larger doors may require two or more dampers
- Karma soft close damper mounts directly over Ferrari hinge while adjustment attributes of hinge remain accessible
- Adjustable close rate control. Plunger contacts hinge cup, not back of door

Karma Dampers		
Part #	Description	
2100168A	Karma for 1/2" overlay	
2100169A	Karma for 1-1/4" & 1-3/8" overlay	



Natural Finished Bottom

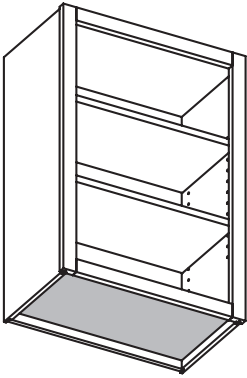

- Advantage line only
- Clear UV finish on Natural Birch veneer on top and bottom of wall cabinets
- To order, specify natural finished bottom
- Use OrderLink or Conestoga order entry for pricing of natural finished bottoms

Omit Shelving

- Choose to omit interior shelving in wall, base and tall cabinets
- Wall and base omit option deletes all shelves
- Tall cabinets: specify top, bottom or all shelves
- Use OrderLink or Conestoga order entry for pricing of omit shelves

Extended Height Option - Tall Cabinets

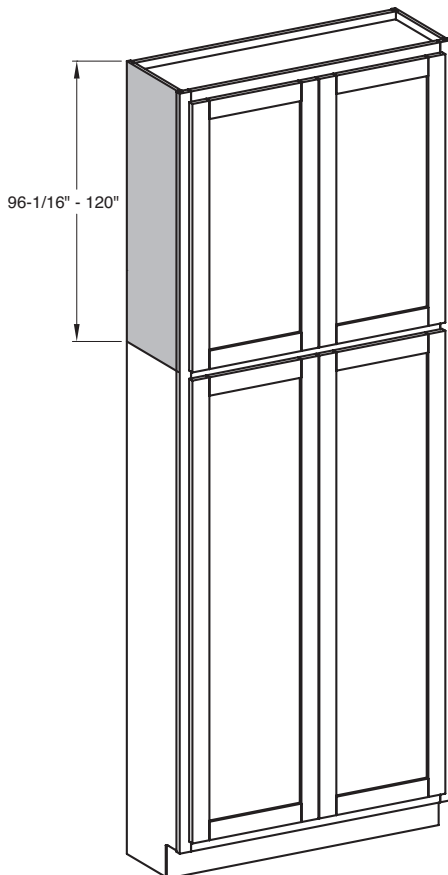

- Choose to extend height of Custom Size Tall Cabinets from 96-1/16" to 120"
- Advantage line only
- Matching interiors not available
- Flush ends only
- Separate 4" high toe platform is available in all heights and is strongly recommended for the extended height option
- When cabinet height changes, top opening height changes accordingly
- Maximum overall height is 120"
- 96-1/16" to 108" tall cabinets have 8 shelves
- 108-1/16" to 120" tall cabinets have 9 shelves